

# A leading player in water

Galliford Try is a leading UK construction group with a strong track record in delivering critical infrastructure across the water sector. Through our Environment business, we design, build, and upgrade essential water and wastewater assets.

13

We work with all 13 major water and wastewater companies in the UK.

18

We have worked for 18 consecutive years, on average, with each client to date.

£1bn+

Order book in Environment.

99%

Of our Environment order book is in frameworks.

57

Frameworks across the water sector.

## Trusted delivery partner

→ Longstanding frameworks with all of the UK's major water and wastewater companies in England, Wales and Scotland.



→ Proven ability to deliver complex, regulated infrastructure projects.

## End-to-end capability

- Full life-cycle capability from feasibility to decommissioning.
- Expertise across both clean water and wastewater systems.
- Growing capability in higher margin Water Technologies businesses providing specialist services.
- 2,000+ highly trained and motivated staff dedicated to the water sector.
- 200+ multi-disciplined engineers focused on developing solutions to meet the affordability challenge.

## Framework and alliance experience

- 57 frameworks across AMP7, AMP8, SR21 and the Environment Agency.
- Collaborative delivery models including joint ventures.

# Market context

The UK water sector is entering a period of significant investment driven by:



AMP8 (2025–2030) capital programmes.



Climate resilience and flood mitigation.



Drive to extend lifespan of facilities.



Ageing infrastructure.



Tightening environmental regulation.

Galliford Try is well positioned to capitalise on these opportunities through its established frameworks and technical expertise.

# Key strengths



## Sector expertise

- Deep understanding of UK water sector and regulatory environment.
- Strong relationships with clients.
- Partner of choice for supply chain (Advantage through Alignment and Fair Payment).



## Sustainability

- Low-carbon construction techniques and Modern Methods of Construction.
- Biodiversity and environmental enhancement.
- Commitment to net zero targets.
- Positive impact on communities.

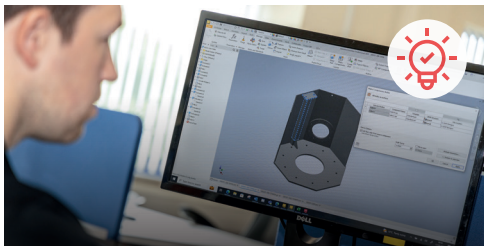

## Innovation

- Digital capability (BIM, digital twin, 4D rehearsals, VR, AR).
- Off-site/modular build.



## Safety & Quality

- Industry-leading health and safety standards.
- Robust quality assurance systems.